

IRM®-1 WATERMANAGER

Rainwater changeover system with self-priming diaphragm pump



rethinking water



PRODUCT DESCRIPTION

The IRM®-1 Watermanager is a plug-in, compact installation for rainwater use in single-family homes. The break tank for drinking water supply is in accordance with EN1717 type AB. Content 3 liters. The IRM®-1 Watermanager has a 24 Volt self-priming membrane pump with automatic pressure control. The motor-controlled ball valve provides for the switch between rainwater and drinking water operation.

Control provides an automatic drinking water refreshment system that regularly switches the system to drinking water. For example, the contents of the break tank are regularly updated and prevent the tap water in the drinking water pipe from being idle for too long. In the absence of rainwater, the system automatically switches to drinking water by means of the float with a 20 meter cable length. The IRM®-1 Watermanager is provided with a sound-proof EPP housing. The 8 liter pressure vessel, including mounting bracket and shut-off valve, ensures optimum operation of the membrane pump. The IRM®-1 Water Manager is suitable for wall and floor mounting. To reduce resonance, the device should be placed, preferably on a solid floor. The device is KIWA, Belgaqua and DVGW certified.

SCOPE

The system is applicable for the use of filtered rainwater for toilet flushing and for the connection of a washing machine. Not suitable for continuous consumers such as sprinkling. The characteristic feature of this pump is the very low energy consumption.

TECHNICAL DATA

Height A in mm:	340
Width B in mm:	340
Depth C in mm:	279
Drinking water connection D:	1/2"
Suction pipe E:	3/4"
Pressure line F:	3/4"
Emergency overflow G in mm:	Ø40
Volume breaktank in liters:	3

TECHNICAL SPECIFICATIONS

Voltage in V:	230
Power in Watt:	98
Maximaal debiet liter/min:	15
Max. opvoerHeight in m:	28
Leeggewicht in kg:	6

MATERIAL

Name	Material
Soundproof hood:	EPP
Breaktank:	HDPE
Pressure vessel:	Staal, vervangbare balg EPDM
Pump house:	Polypropyleen
Membrane:	Santoprene
Motor housing:	RVS
Electro cable pump:	3 aderig 1,00 mm ² H07Rn-F
Press-suction side:	Messing

TECHNICAL DRAWINGS

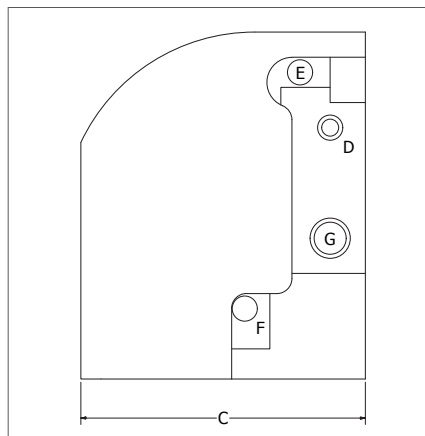
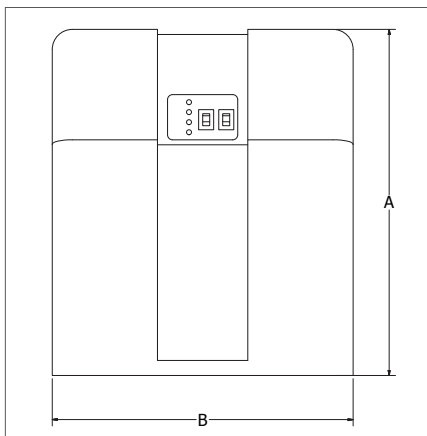

PUMP CHARACTERISTIC

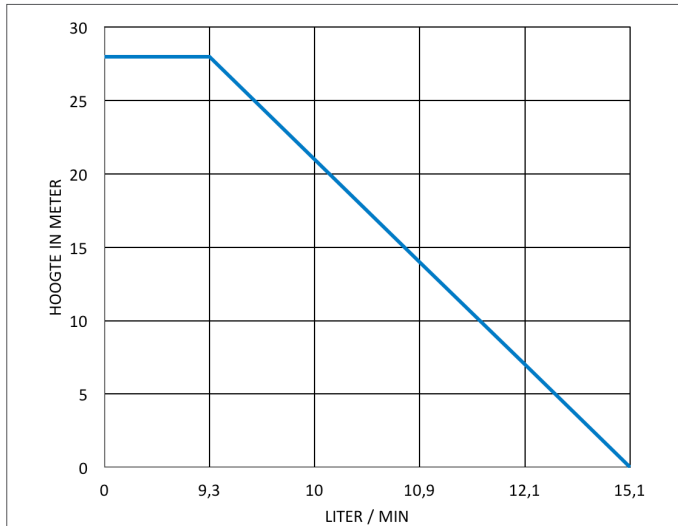

CONNECTION DIAGRAM

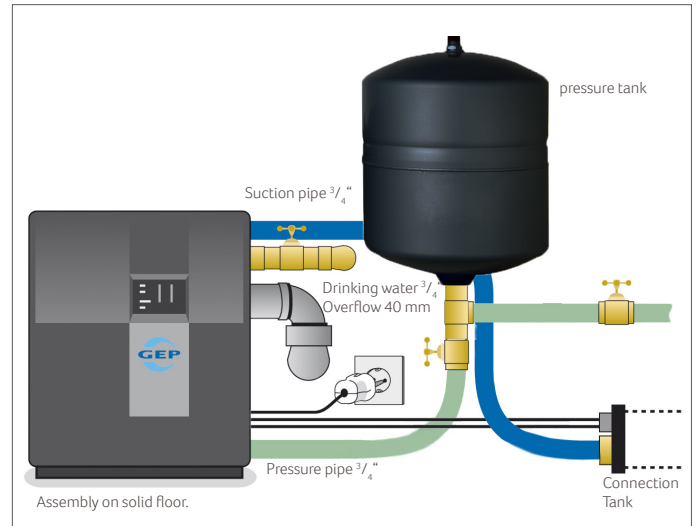

OPTIONS

IRM@-1 water lock

If there is no Emergency overflow connection present, the device can be extended with a water seal, which closes the drinking water supply when a leaking drinking water valve is.

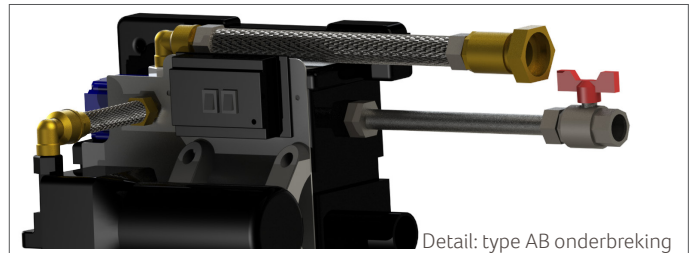

SCOPE OF DELIVERY

The IRM@-1 Watermanager is supplied with: sound-insulating foam hood, flexible stainless steel hoses for connection of the drinking water, suction and pressure line including shut-off valves, float with 20 meter cable and cable clamp for tank mounting, mains cable of 2 meters, pressure vessel 8 liters including mounting bracket and shut-off valve and installation instructions.

ORDERING INFORMATION

Art nr	NAME	PG
402101	IRM@-1 Watermanager	1
402234	Waterslot IRM@-1	1

